

## SPECIFICATION

IMAGE FORMAT	1/3"
FOCAL LENGTH	3.6mm
F.O.V.	104°(D)
	75°(H)
	58°(V)
RESOLUTION	3Megapixel
APERTURE	F2.0
MOUNT	M12X0.5
IRIS	Fixed
FOCUS	Manual
ZOOM	Fixed
B.F.L.	7.1mm
M.O.D.	0.3m
IR	Corrected

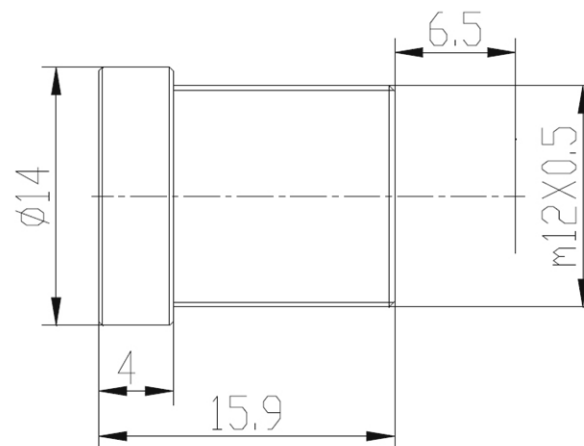

SCALE		DRAWN		MODEL	<b>CCL13036MPR2</b>	REV	DESCRIPTION	DATE	NAME
DATE		CHECK		 香港致远电子集团有限公司 HONGKONG TOWIN ELECTRONICS CO.,LTD.		①			
UNIT	mm	APPROVE				②			
						③			