

# SPECIFICATION

IMAGE FORMAT	1/2"
FOCAL LENGTH	35mm
F.O.V.	12.5°(D)
	10°(H)
	7.6°(V)
RESOLUTION	MP
DISTORTION	<0.29%
APERTURE	F2.0
MOUNT	M12x0.5
B.F.L.	19.1mm
IRIS	Fixed
M.O.D.	0.5m

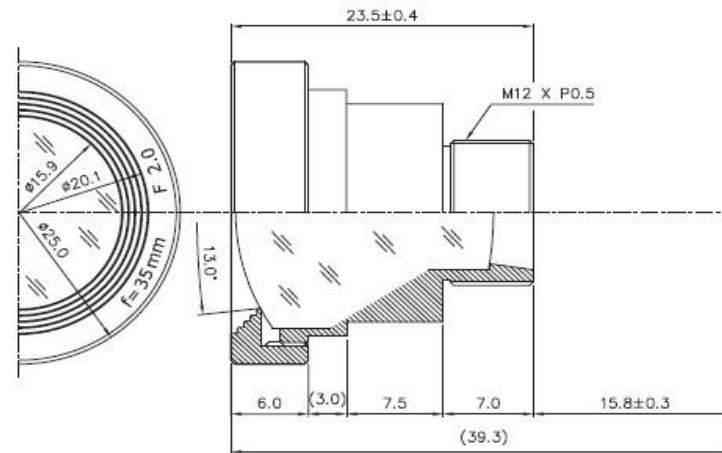

SCALE		DRAWN		MODEL	<b>CCL1235MP</b>	REV	DESCRIPTION	DATE	NAME
DATE		CHECK		 香港致远电子集团有限公司 HONGKONG TOWIN ELECTRONICS CO.,LTD.		①			
UNIT	mm	APPROVE				②			
						③			